

# AFD FIRE VEHICLE MAINTENANCE FACILITY VIDEO SYSTEM UPGRADE

FOR THE

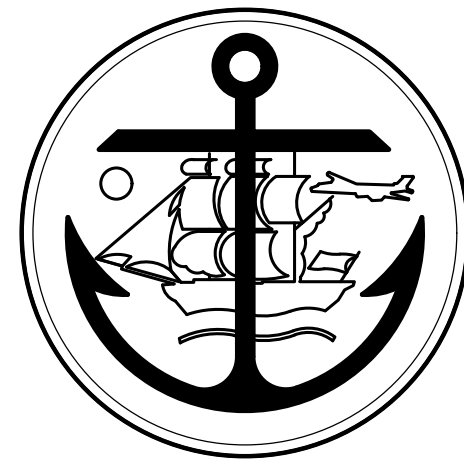

## MUNICIPALITY OF ANCHORAGE MAINTENANCE AND OPERATIONS

# 100% CONSTRUCTION DOCUMENTS FEBRUARY 13, 2026

PREPARED BY:

**R S A**

**Engineering, Inc.**

MECHANICAL AND ELECTRICAL CONSULTING ENGINEERS

670 W. Fireweed Lane  
Anchorage, AK 99503  
Phone (907) 276-0521  
Fax (907) 276-1751  
Corporate No.: AECC542

### INDEX TO DRAWINGS:

- T100 COVER SHEET
- E001 ELECTRICAL LEGEND, CAMERA SCHEDULE, AND VIDEO SYSTEM ONE-LINE DIAGRAM
- E002 ELECTRICAL SPECIFICATIONS
- E003 ELECTRICAL DETAILS
- E101 VIDEO SYSTEM SITE DEMOLITION PLAN
- E102 VIDEO SYSTEM SITE REMODEL PLAN
- E201 MAINTENANCE BUILDING VIDEO SYSTEM DEMOLITION PLAN
- E301 MAINTENANCE BUILDING VIDEO SYSTEM REMODEL PLAN

#### PROJECT SUMMARY

PROJECT INCLUDES A REPLACEMENT AND EXPANSION  
OF THE EXISTING FACILITIES VIDEO SURVEILLANCE  
SYSTEM.

### PROJECT LOCATION

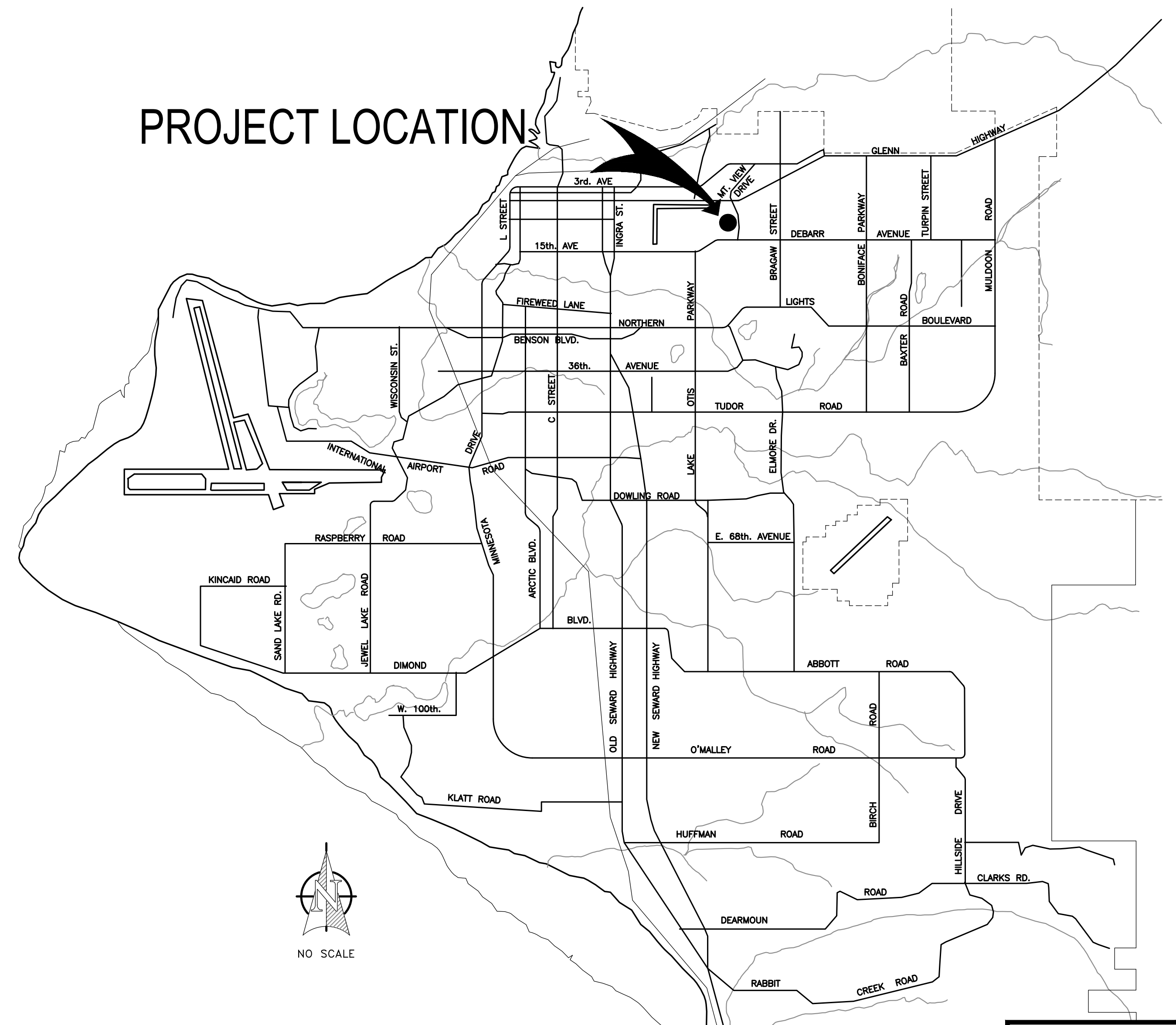

SHEET:  
**T100**



**RISA**  
**Engineering, Inc.**  
 MECHANICAL AND ELECTRICAL CONSULTING ENGINEERS  
 670 West Friedland Lane, Suite 200  
 Anchorage, AK 99503  
 Phone (907) 276-0521  
 Corporate No.: AEC0542

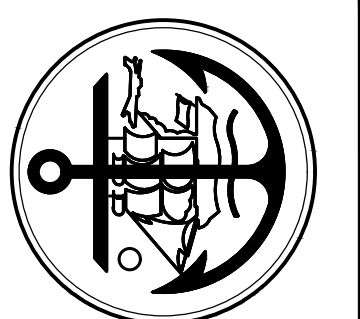

**MUNICIPALITY OF ANCHORAGE**  
**AFD FIRE VEHICLE MAINTENANCE FACILITY**  
**VIDEO SYSTEM REPLACEMENT**  
 1000 AIRPORT HEIGHTS,  
 ANCHORAGE, AK 99508

REVISIONS:

DRAWN BY: NDZ  
 CHECKED BY: CSZ,JAM  
 DATE: 2/13/2026  
 JOB NUMBER: M5136  
 DWG FILE: ESERIES

DRAWING TITLE:  
 ELECTRICAL LEGEND,  
 CAMERA SCHEDULE, AND  
 VIDEO SYSTEM  
 ONE-LINE DIAGRAM

SHEET:  
**E001**

100% CONSTRUCTION DOCUMENTS

**SHEET NOTES**

1. REPLACE EXISTING CLIENT WORKSTATION AND MONITOR WITH NEW IN SAME LOCATION. RECONNECT TO EXISTING NETWORK CABLING. SEE 1/E102 1/E202 FOR LOCATIONS.
2. EXISTING POE SWITCHES IN EXISTING RACKS SHALL BE UTILIZED FOR VIDEO SYSTEM.
3. PROVIDE NEW RJ-45 VIDEO JACK IN CAMERA BACKBOX.
4. EXISTING TELECOM OUTLET.
5. EXISTING RJ-45 VIDEO SYSTEM JACK IN CAMERA BACKBOX. FOR EXISTING INTERIOR CAMERA LOCATIONS EXISTING FIELD PATCH CORD MAY BE REUSED WHERE IN COMPLIANCE WITH THE SPECIFICATIONS.
6. FOR ALL EXTERIOR CAMERAS, PATCH CABLE TO CAMERA SHALL BE EXTERIOR RATED.
7. CONTRACTOR SHALL VERIFY ALL VIDEO CAMERAS ARE INSTALLED AT SUCH A LOCATION AND HEIGHT THAT CAMERA VIEWS ARE NOT OBSTRUCTED BY NORMAL FACILITY OPERATIONS. COORDINATE WITH FACILITY PERSONNEL PRIOR TO ROUGH-IN.

**VIDEO SYSTEM CABLE SCHEDULE**  
 AS SPECIFIED IN SECTION 282300, SEE SHEET E002

CABLE NUMBER	DESCRIPTION
1	NEW CAMERA PoE CABLE, CAT 6 UTP
2	EXISTING CAMERA PoE CABLE
3	EXISTING NETWORK CABLE
4	NEW CAMERA FIELD PATCH CORD LENGTH AS REQUIRED.
5	EXISTING CROSS CONNECT PATCH CORD.

**LEGEND**

	IP VIDEO CAMERA (WALL MOUNTED)
	IP VIDEO CAMERA (CEILING MOUNTED)
	CAMERA TO BE REMOVED (DASHED OR DOTTED LINES INDICATE ITEMS TO BE REMOVED TYPICAL)
	NOTE TAG (No. INDICATES NOTE)
AFF	ABOVE FINISHED FLOOR
E	DENOTES EXISTING ITEM
MOA	MUNICIPALITY OF ANCHORAGE
NEC	NATIONAL ELECTRICAL CODE
TYP	TYPICAL
UON	UNLESS OTHERWISE NOTED

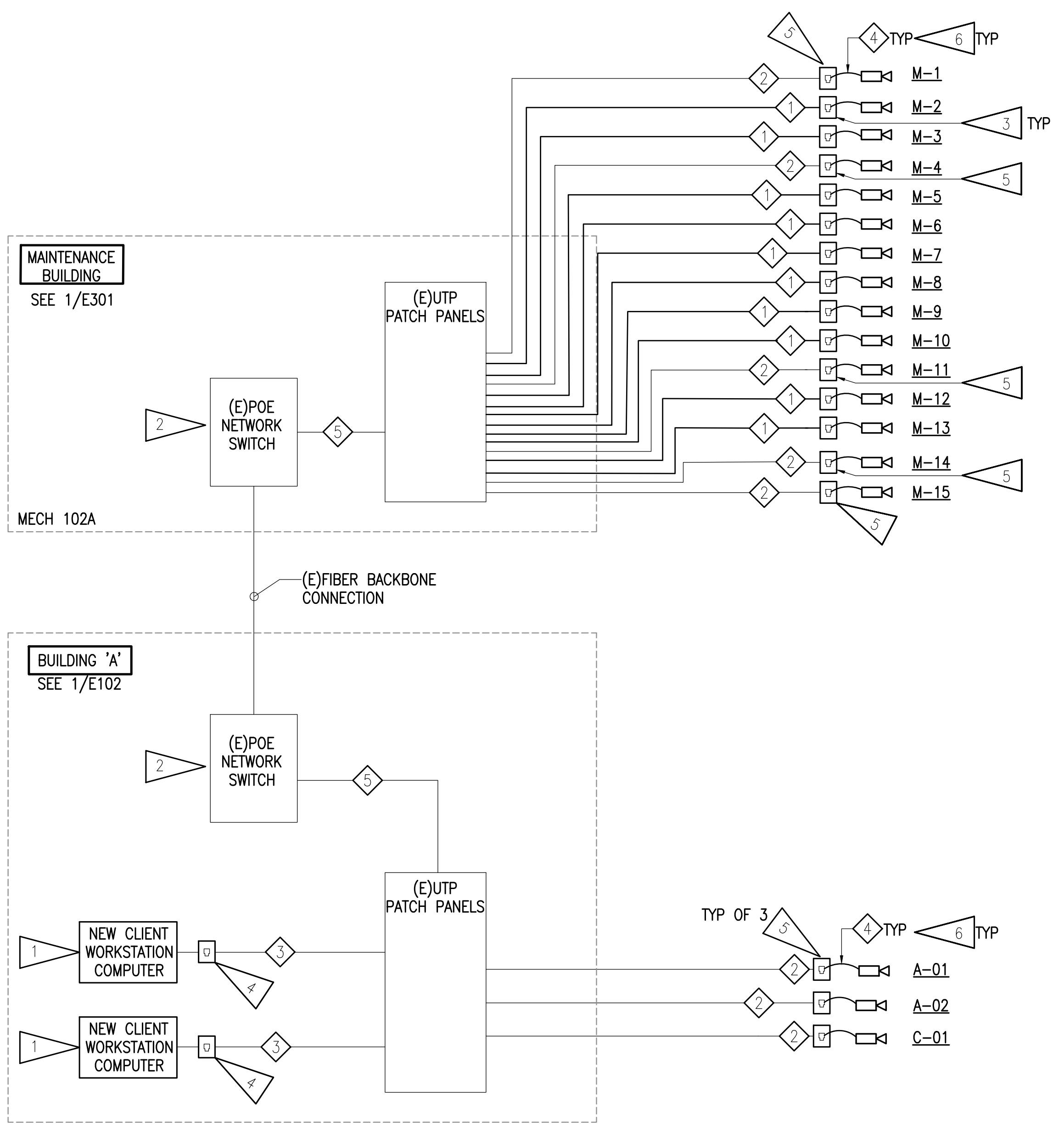

**IP VIDEO SYSTEM CAMERA SCHEDULE**

CAMERA DESIGNATION	CAMERA LOCATION (SEE PLANS)	INTENDED COVERAGE AREA	CAMERA TYPE (SEE SPECS)	MOUNTING TYPE	NEW AT/NEAR EXISTING LOCATION	HEIGHT
M-01	EXTERIOR SOUTHWEST CORNER - MAINTENANCE BUILDING	GENERAL COVERAGE OF PARKING AND ENTRANCE.	TYPE 'A'	WALL MOUNT, ARM	X	MATCH EXISTING
M-02	STORAGE 104 - MAINTENANCE BUILDING	GENERAL COVERAGE OF STORAGE ROOM.	TYPE 'B'	WALL MOUNT		+8' AFF
M-03	EXTERIOR SOUTHEAST CORNER - MAINTENANCE BUILDING	GENERAL COVERAGE OF PARKING AND ENTRANCE.	TYPE 'A'	WALL MOUNT, ARM		MATCH M-01
M-04	BAY 1 WEST - MAINTENANCE BUILDING	GENERAL COVERAGE OF BAY	TYPE 'C'	WALL MOUNT, ARM	X	MATCH EXISTING
M-05	BAY 1 EAST - MAINTENANCE BUILDING	GENERAL COVERAGE OF BAY	TYPE 'C'	WALL MOUNT		+15' AFF
M-06	BAY 2 WEST - MAINTENANCE BUILDING	GENERAL COVERAGE OF BAY	TYPE 'C'	WALL MOUNT, ARM		+15' AFF
M-07	BAY 2 EAST - MAINTENANCE BUILDING	GENERAL COVERAGE OF BAY	TYPE 'C'	WALL MOUNT, ARM		+15' AFF
M-08	BAY 3 WEST - MAINTENANCE BUILDING	GENERAL COVERAGE OF BAY	TYPE 'C'	SURFACE MOUNT		+15' AFF
M-09	BAY 3 EAST - MAINTENANCE BUILDING	GENERAL COVERAGE OF BAY	TYPE 'C'	SURFACE MOUNT		+15' AFF
M-10	BAY 4 WEST - MAINTENANCE BUILDING	GENERAL COVERAGE OF BAY	TYPE 'B'	WALL MOUNT		+15' AFF
M-11	BAY 4 EAST - MAINTENANCE BUILDING	GENERAL COVERAGE OF BAY	TYPE 'C'	WALL MOUNT, ARM	X	MATCH EXISTING
M-12	BAY 4 WEST - MAINTENANCE BUILDING	GENERAL COVERAGE OF BAY	TYPE 'C'	WALL MOUNT		+15' AFF
M-13	BAY 4 EAST - MAINTENANCE BUILDING	GENERAL COVERAGE OF BAY	TYPE 'C'	WALL MOUNT		+15' AFF
M-14	BAY 5 SOUTH - MAINTENANCE BUILDING	GENERAL COVERAGE OF BAY	TYPE 'B'	WALL MOUNT	X	MATCH EXISTING
M-15	BAY 5 NORTH - MAINTENANCE BUILDING	GENERAL COVERAGE OF BAY	TYPE 'B'	WALL MOUNT	X	MATCH EXISTING
A-01	WEST ENTRANCE MAINTENANCE BUILDING A	GENERAL COVERAGE OF BUILDING ENTRANCE	TYPE 'D'	WALL MOUNT, ARM	X	MATCH EXISTING
A-02	AIRPORT HEIGHT ENTRANCE BUILDING A	GENERAL COVERAGE OF BUILDING ENTRANCE	TYPE 'A'	WALL MOUNT, ARM	X	MATCH EXISTING
C-01	GARAGE DOORS BUILDING B	GENERAL COVERAGE SOUTH BUILDING B AND BUILDING C	TYPE 'D'	WALL MOUNT, ARM	X	MATCH EXISTING

**1 VIDEO SYSTEM ONE-LINE DIAGRAM**  
 NO SCALE

# ELECTRICAL SPECIFICATIONS

## 26 05 00 – COMMON WORK RESULTS FOR ELECTRICAL

- A. SCOPE OF WORK: FURNISH AND INSTALL ALL MATERIAL AND EQUIPMENT FOR AN EXTENSION TO THE EXISTING VIDEO SYSTEM AS INDICATED ON THE DRAWINGS AND IN THESE SPECIFICATIONS.
- B. STANDARDS, CODES AND REGULATIONS: COMPLY WITH THE LATEST ADOPTED EDITION OF THE NATIONAL ELECTRICAL CODE, INTERNATIONAL BUILDING CODE, AND INTERNATIONAL FIRE CODE, INCLUDING ALL STATE AND LOCAL AMENDMENTS TO THESE CODES. COMPLY WITH THE LATEST PUBLISHED VERSION OF THE NECA STANDARD OF INSTALLATION.
- C. DRAWINGS: THE DRAWINGS ARE DIAGRAMMATIC, NOT NECESSARILY SHOWING ALL OFFSETS OR EXACT LOCATIONS OF CAMERAS UNLESS SPECIFICALLY DIMENSIONED. BRING QUESTIONABLE OR OBSCURE ITEMS, APPARENT CONFLICTS BETWEEN PLANS AND SPECIFICATIONS, GOVERNING CODES OR UTILITIES REGULATIONS TO THE ATTENTION OF THE OWNER. CODES, ORDINANCES, REGULATIONS, MANUFACTURER'S INSTRUCTIONS OR STANDARDS TAKE PRECEDENCE WHEN THEY ARE MORE STRINGENT OR CONFLICT WITH THE DRAWINGS AND SPECIFICATIONS.
- D. RECORD DRAWINGS: MARK UP A CLEAN SET OF DRAWINGS AS THE WORK PROGRESSES TO SHOW THE INSTALLED SYSTEM.
- E. WORKMANSHIP: INSTALLATION OF ALL WORK SHALL BE MADE SO THAT ITS SEVERAL COMPONENT PARTS SHALL FUNCTION AS A WORKABLE SYSTEM COMPLETE WITH ALL ACCESSORIES NECESSARY FOR ITS OPERATION. ALL MATERIAL AND EQUIPMENT SHALL BE INSTALLED IN ACCORDANCE WITH THE MANUFACTURER'S RECOMMENDATIONS, INSTRUCTIONS AND/OR INSTALLATION DRAWINGS AND IN ACCORDANCE WITH NECA STANDARDS. MATERIALS AND EQUIPMENT SHALL BE NEW AND SHALL CONFORM WITH APPLICABLE INDUSTRY STANDARDS, NEMA STANDARDS AND UNDERWRITERS LABORATORIES STANDARDS WHERE APPLICABLE.
- F. SUBMITTALS: PROVIDE MATERIAL AND EQUIPMENT SUBMITTALS CONTAINING A COMPLETE LISTING OF MATERIAL AND EQUIPMENT SHOWN ON THE DRAWINGS. INCLUDE CATALOG NUMBERS, WIRING DIAGRAMS, ROUGH-IN DIMENSIONS AND PERFORMANCE DATA FOR ALL MATERIAL AND EQUIPMENT. SUBMITTALS SHALL BE IN ELECTRONIC .PDF FORMAT, SEPARATE FROM WORK FURNISHED UNDER OTHER DIVISIONS. INDEX AND CLEARLY IDENTIFY ALL MATERIAL AND EQUIPMENT BY ITEM, NAME OR DESIGNATION USED ON THE DRAWINGS. SUBMITTAL REVIEW IS FOR GENERAL DESIGN AND ARRANGEMENT ONLY AND DOES NOT RELIEVE THE CONTRACTOR FROM ANY REQUIREMENTS OF THE CONTRACT DOCUMENTS. THE SUBMITTALS ARE NOT CHECKED FOR QUANTITY, DIMENSION, OR FOR PROPER OPERATION. WHERE DEVIATIONS OF A SUBSTITUTE PRODUCT OR SYSTEM PERFORMANCE HAVE NOT BEEN SPECIFICALLY NOTED IN THE SUBMITTAL BY THE CONTRACTOR, PROVISIONS OF A COMPLETE AND SATISFACTORY WORKING INSTALLATION IS THE SOLE RESPONSIBILITY OF THE CONTRACTOR.
- G. OPERATION AND MAINTENANCE MANUALS: PROVIDE OPERATION AND MAINTENANCE MANUALS. DESCRIBE THE PROCEDURES NECESSARY TO OPERATE THE SYSTEM INCLUDING START-UP, OPERATION, AND SHUTDOWN. PROVIDE MANUFACTURER'S DESCRIPTIVE LITERATURE INCLUDING APPROVED SHOP DRAWINGS COVERING DEVICES USED IN ANY CONTRACTOR-PROVIDED EQUIPMENT OR SYSTEMS WITH ILLUSTRATION, EXPLODED VIEWS, ETC.
- H. WARRANTY: THE CONTRACTOR SHALL GUARANTEE ALL WORK EXECUTED UNDER THIS CONTRACT TO BE FREE FROM DEFECTS IN MATERIALS AND WORKMANSHIP FOR A PERIOD OF ONE YEAR FROM BENEFICIAL OCCUPANCY. ANY FAULTY MATERIALS OR WORKMANSHIP SHALL BE REPAIRED OR REPLACED TO THE SATISFACTION OF THE OWNER DURING THE GUARANTEE PERIOD.
- I. REFERENCE SYMBOLS: THE ELECTRICAL "LEGEND" ON THE DRAWINGS IS A STANDARDIZED VERSION, AND ALL SYMBOLS SHOWN MAY NOT BE USED. USE THE "LEGEND" AS A REFERENCE FOR THE SYMBOLS USED ON THE DRAWINGS.
- J. PERMITS – SECURE AND PAY FOR ALL FEES, PERMITS, ETC. AS REQUIRED BY LOCAL AND STATE AGENCY.

## 26 05 33 – RACEWAY AND BOXES FOR ELECTRICAL SYSTEMS

- A. SUBMITTALS: NONE REQUIRED FOR THIS SECTION.
- B. MATERIALS
  1. ELECTRICAL METALLIC TUBING CONDUIT (EMT): ANSI C80.3. GALVANIZED TUBING. FITTINGS AND CONDUIT BODIES: ANSI/NEMA FB 1; STEEL OR MALLEABLE IRON, COMPRESSION TYPE OR SET SCREW FITTINGS WITH INSULATED THROAT BUSHINGS. DIE-CAST FITTINGS ARE NOT ACCEPTABLE.
  2. LIQUIDTIGHT FLEXIBLE CONDUIT: FLEXIBLE METAL CONDUIT WITH PVC JACKET. FITTINGS AND CONDUIT BODIES: ANSI/NEMA FB 1; STEEL OR MALLEABLE IRON WITH INSULATED THROAT BUSHINGS. DIE CAST FITTINGS ARE NOT ACCEPTABLE.
  3. PROVIDE GALVANIZED OR CADMIUM PLATED, ONE PIECE PRESSED STEEL OUTLET BOXES 4-11/16 INCH SQUARE, 2-1/4 INCHES DEEP MINIMUM SIZE.
  4. PROVIDE CAST ALUMINUM OR FERROALLOY TYPE BOXES WITH GASKETED COVER, THREADED HUBS AND NEMA 3R RATING FOR USE IN EXTERIOR LOCATIONS.
- C. INSTALLATION:
  1. INSTALL CONDUIT FOR ALL CABLING AS SHOWN ON THE DRAWINGS. WHERE CONDUIT SLEEVES ARE INDICATED, PROVIDE 3/4" MINIMUM.
  2. PROVIDE BOXES AS REQUIRED FOR WIRE PULLING AND DEVICE INSTALLATION.

## 28 23 00 – VIDEO SURVEILLANCE

- A. SUMMARY: THIS SECTION INCLUDES AN EXTENSION OF THE EXISTING VIDEO SURVEILLANCE SYSTEM IN THE FACILITY COMPLETE WITH INTERIOR AND EXTERIOR IP CAMERAS, CABLING TO NEW CAMERAS AND CLIENT WORKSTATION & MONITORS. ALL CAMERAS SHALL BE CONNECTED TO THE EXISTING VIDEO STORAGE APPLIANCE AND SURVEILLANCE SHALL BE ACCESSIBLE VIA NETWORK CONNECTION FROM REMOTE LOCATIONS. IF REQUIRED, ADDITIONAL STORAGE WILL BE PROVIDED BY MOA.
- B. SUBMITTALS: SUBMIT PRODUCT DATA AND DETAILED SHOP DRAWINGS FOR APPROVAL.
- C. MATERIALS:
  2. CLIENT WORKSTATION: LENOVO #30HT006XUS DESKTOP OR APPROVED EQUAL.
  3. MONITOR: LENOVO #63B4GAR6US OR APPROVED EQUAL.
  4. VIDEO CAMERAS:
    - a. TYPE 'A' – OUTDOOR DAY/NIGHT 2 MEGAPIXEL IP MINI-DOME: AXIS #P3738-PLR OR APPROVED EQUAL.
    - b. TYPE 'B' – INDOOR/OUTDOOR DAY/NIGHT VANDAL-RESISTANT 2 MEGAPIXEL IP DUAL SENSOR: AXIS #P4705-PLVE OR APPROVED EQUAL.
    - c. TYPE 'C' – INDOOR DAY/NIGHT VANDAL-RESISTANT 2 MEGAPIXEL IP MINI-DOME: AXIS #P3265-V OR APPROVED EQUAL.
    - d. TYPE 'D' – INDOOR/OUTDOOR DAY/NIGHT BULLET CAMERA: AXIS #P1468-LE OR APPROVED EQUAL.
  4. GENERAL HARDWARE AND MOUNTS: AS REQUIRED FOR A COMPLETE AND OPERABLE SYSTEM.
  5. UTP TELECOMMUNICATION CABLE: PLENUM-RATED CL2P, CATEGORY 6, 4 PAIR, 24 AWG, SOLID COPPER CONDUCTOR TELECOMMUNICATIONS CABLE WITH GREEN JACKET. SUPERIOR ESSEX "DATAGAIN" CMP OR APPROVED EQUAL.
  6. UTP TELECOMMUNICATIONS JACK: RJ-45, CATEGORY 6, T568A/B, 8P8C, SINGLE, GREEN FINISH, TELECOMMUNICATIONS JACK WITH FLUSH EXIT WITH SINGLE-GANG FACEPLATES WITH FINISH TO MATCH JACK. ORTRONICS TRACJACK CLARITY 6" #OR-TJ600 OR APPROVED EQUAL.
  7. PATCH CABLES – ALL PATCH CABLES SHALL BE FACTORY MANUFACTURED TO MATCH THE APPLICABLE CABLE/CONNECTIVITY SOLUTION (I.E. THE SUPERIOR ESSEX/ORTRONICS SYSTEM SHALL USE ORTRONICS MANUFACTURED PATCH CORDS, ETC.). PROVIDE ONE PATCH CABLE FOR EACH NEW CABLE TERMINATED IN THE CABINET.
  8. CABLE SUPPORT: ALL CABLES NOT INSTALLED IN CONDUIT SHALL BE SUPPORTED USING J-HOOKS, CADDY CABLECAT SERIES OR APPROVED EQUAL. SIZE ALL J-HOOKS TO SUPPORT THE QUANTITY OF CABLES INSTALLED, PLUS A MINIMUM OF 25% SPARE CAPACITY.
- D. INSTALLATION:
  4. UNLESS OTHERWISE NOTED, ALL CABLES SHALL BE INSTALLED IN CONDUIT FROM THE TELECOMMUNICATIONS JACK TO THE SPACE ABOVE THE ACCESSIBLE CEILING AND IN CONDUIT THROUGH INACCESSIBLE AREAS. SUPPORT CABLES INSTALLED IN CEILING SPACES WITH J-HOOKS ANCHORED TO THE ROOF STRUCTURE. MAXIMUM SPACING BETWEEN SUPPORTS SHALL BE 4 FEET, MAXIMUM NUMBER OF CABLES ON EACH SUPPORT SHALL BE 25. CABLES SHALL BE ROUTED A MINIMUM OF 5 INCHES FROM POWER LINES 2 KVA OR LESS, 12 INCHES FROM FLUORESCENT OR HID BALLASTS, 36 INCHES FROM POWER LINES 5 KVA OR GREATER, 40 INCHES FROM TRANSFORMERS AND MOTORS. STORE A MAXIMUM OF 12 INCHES OF SLACK CABLE AT EACH OUTLET AND A MINIMUM OF 10 FEET OF SLACK CABLE AT EACH RACK. CABLE JACKET SHALL BE MAINTAINED TO WITHIN .5 INCH OF JACK AND TWISTS SHALL BE MAINTAINED TO WITHIN .25 INCH OF TERMINATION POINT. COMPLY WITH CABLE MANUFACTURERS MAXIMUM PULLING TENSION AND MINIMUM BEND RADIUS REQUIREMENTS. DO NOT STRETCH, STRESS, TIGHTLY COIL, BEND OR CRIMP CABLES. CABLES SHALL BE ROUTED SO THAT CABLE LENGTHS DO NOT EXCEED 90 METERS PER ANSI/TIA REQUIREMENTS. PERFORM END-TO-END TESTS OF EACH CABLE AFTER INSTALLATION AND TERMINATION TO SHOW COMPLIANCE WITH ANSI/TIA REQUIREMENTS.
  5. UTP CABLE SHALL BE TESTED FOR COMPLIANCE WITH TIA 568 CATEGORY 6 STANDARDS AFTER INSTALLATION USING A FLUKE #DSX OR APPROVED EQUAL TESTER. PROVIDE TEST RESULTS FOR ALL TESTS NOTED ABOVE IN THE FORM OF PRINTOUTS FROM THE TEST EQUIPMENT AND PROVIDE AN ELECTRONIC COPY OF THE TEST DATA FOR EACH CABLE. WHERE ANY PORTION OF THE SYSTEM DOES NOT MEET THE SPECIFICATIONS, THE CONTRACTOR SHALL CORRECT THE DEVIATION AND REPEAT ANY APPLICABLE TESTING AT NO ADDITIONAL COST TO THE OWNER. ACCEPTANCE OF THE TELECOMMUNICATIONS SYSTEM SHALL BE BASED ON THE RESULTS OF THE ABOVE TESTS, FUNCTIONALITY, AND THE RECEIPT OF DOCUMENTATION.
  6. NO WIRING OTHER THAN THAT DIRECTLY ASSOCIATED WITH THE VIDEO SURVEILLANCE SYSTEM SHALL BE PERMITTED IN VIDEO SURVEILLANCE SYSTEM CONDUITS AND PATHWAYS.
  7. COORDINATE ALL FINAL CAMERA LOCATIONS WITH OWNER'S REPRESENTATIVE PRIOR TO ROUGH-IN AND AVOID CONFLICTS WITH EXISTING EQUIPMENT AND OBJECTS THAT MAY OBSTRUCT THE FIELD OF VIEW OR, IN THE CASE OF LIGHT FIXTURES, MAY AFFECT THE CAMERA PERFORMANCE AND QUALITY OF THE VIDEO IMAGE.
  8. COORDINATE ALL CAMERA, OUTLET BOX, AND CONDUIT LOCATIONS TO AVOID CONFLICTS WITH MECHANICAL PIPING AND DUCTWORK, STRUCTURAL MEMBERS, AND OTHER MATERIALS ABOVE THE ACCESSIBLE CEILINGS AND ALONG THE ENTIRE CABLE PATHWAY.
  9. ANY CAMERA THAT IS LOCATED SO THAT CAMERA PERFORMANCE OR FIELD OF VIEW IS ADVERSELY AFFECTED SHALL BE RELOCATED BY THE CONTRACTOR AT NO ADDITIONAL COST TO THE OWNER.
  10. LABEL ALL VIDEO SURVEILLANCE SYSTEM JUNCTION BOXES. FOR JUNCTION BOXES ABOVE CEILINGS, MARK THE BOX COVER WITH "VIDEO" USING PERMANENT BLACK MARKER. FOR JUNCTION BOXES IN FINISHED AREAS, MARK THE INSIDE OF THE COVER.
  11. FIXED CAMERAS: THE CONTRACTOR SHALL COORDINATE WITH THE OWNER TO OBTAIN THE DESIRED FIELD OF VIEW FOR EACH NEW CAMERA. THIS INCLUDES, BUT IS NOT LIMITED TO, ADJUSTING CAMERA AIMING POINT, WHITE BALANCE, BACKLIGHT COMPENSATION, AGC, IRIS CONTROL, VIEWING ANGLE, AND ADJUSTING VARI-FOCAL LENSES.
  12. INSTALL AND TEST IN ACCORDANCE WITH THE MANUFACTURER'S RECOMMENDATIONS.
  13. TRAINING: FURNISH 4 HOURS OF INSTRUCTION IN ONE TRAINING SESSION FOR TWO PERSONS, TO BE CONDUCTED AT PROJECT SITE WITH MANUFACTURER'S REPRESENTATIVE.



**RISA**  
**Engineering, Inc.**  
 MECHANICAL AND ELECTRICAL CONSULTING ENGINEERS  
 670 West Freewood Lane, Suite 200  
 Anchorage, AK 99503  
 Phone (907) 276-0521  
 Corporate No.: AECC542

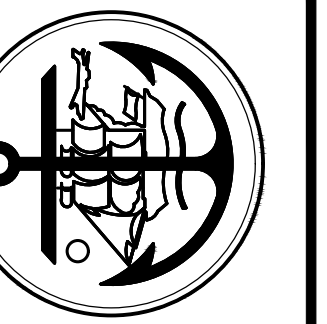

**MUNICIPALITY OF ANCHORAGE**  
**AFD FIRE VEHICLE MAINTENANCE FACILITY**  
**VIDEO SYSTEM REPLACEMENT**  
 1000 AIRPORT HEIGHTS,  
 ANCHORAGE, AK 99508

REVISIONS:

DRAWN BY: NDZ  
 CHECKED BY: CSZ,JAM  
 DATE: 2/13/2026  
 JOB NUMBER: M5136  
 DWG FILE: ESERIES

DRAWING TITLE:  
 ELECTRICAL  
 SPECIFICATIONS

SHEET:  
**E002**

100% CONSTRUCTION DOCUMENTS

0"  
1"  
2"  
3"

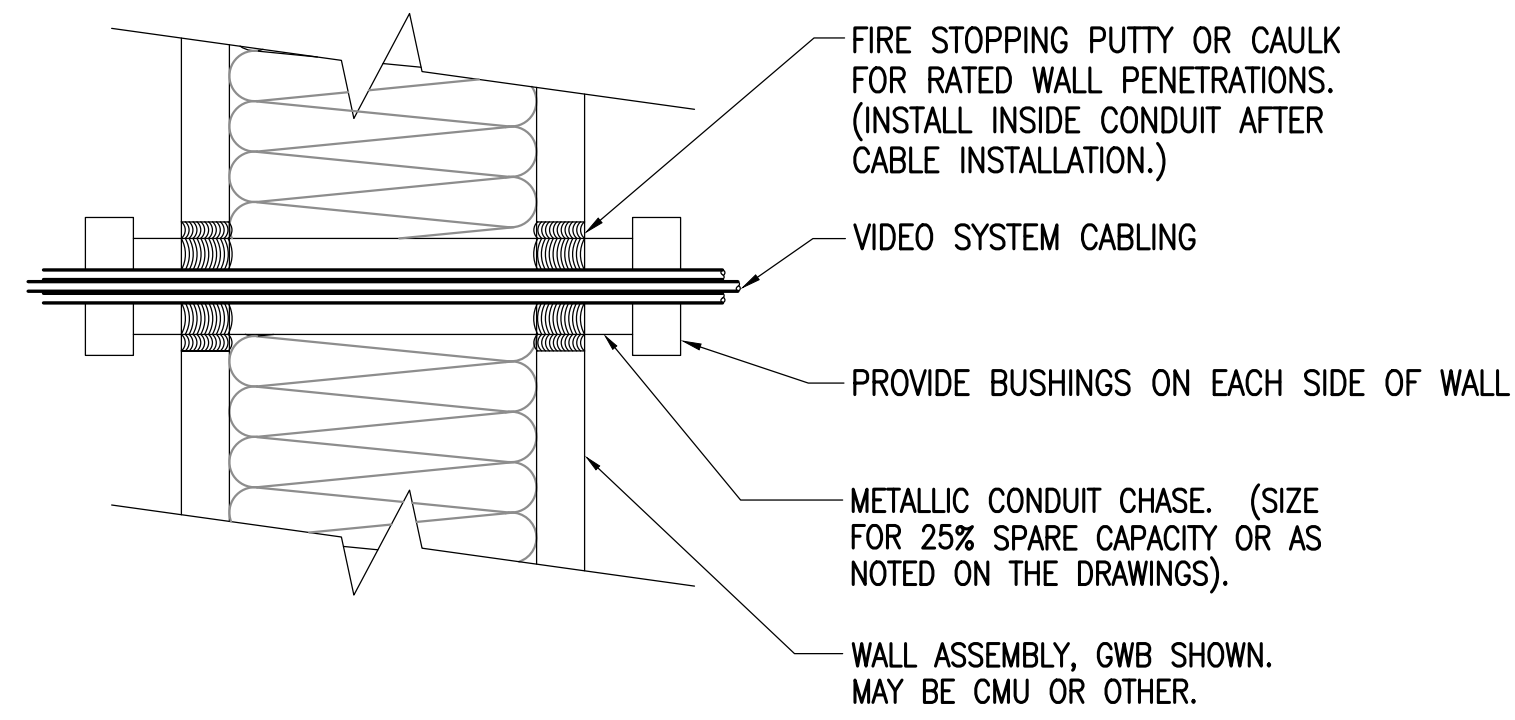

**DETAIL NOTES:**

- A. THE PENETRATION SHALL BE A LISTED FIRE RATED SYSTEM AS REQUIRED BY THE RATING AND CONSTRUCTION TYPE OF THE WALL.
- B. PROVIDE UL LISTED FIRE STOPPING PER MANUFACTURER'S RECOMMENDATIONS AT ALL FIRE WALLS WHICH ARE PENETRATED.
- C. PENETRATIONS IN NON-RATED WALLS SHALL BE SEALED WITH SILICONE OR SIMILAR.

**1 TYPICAL WALL PENETRATION DETAIL**  
NOT TO SCALE

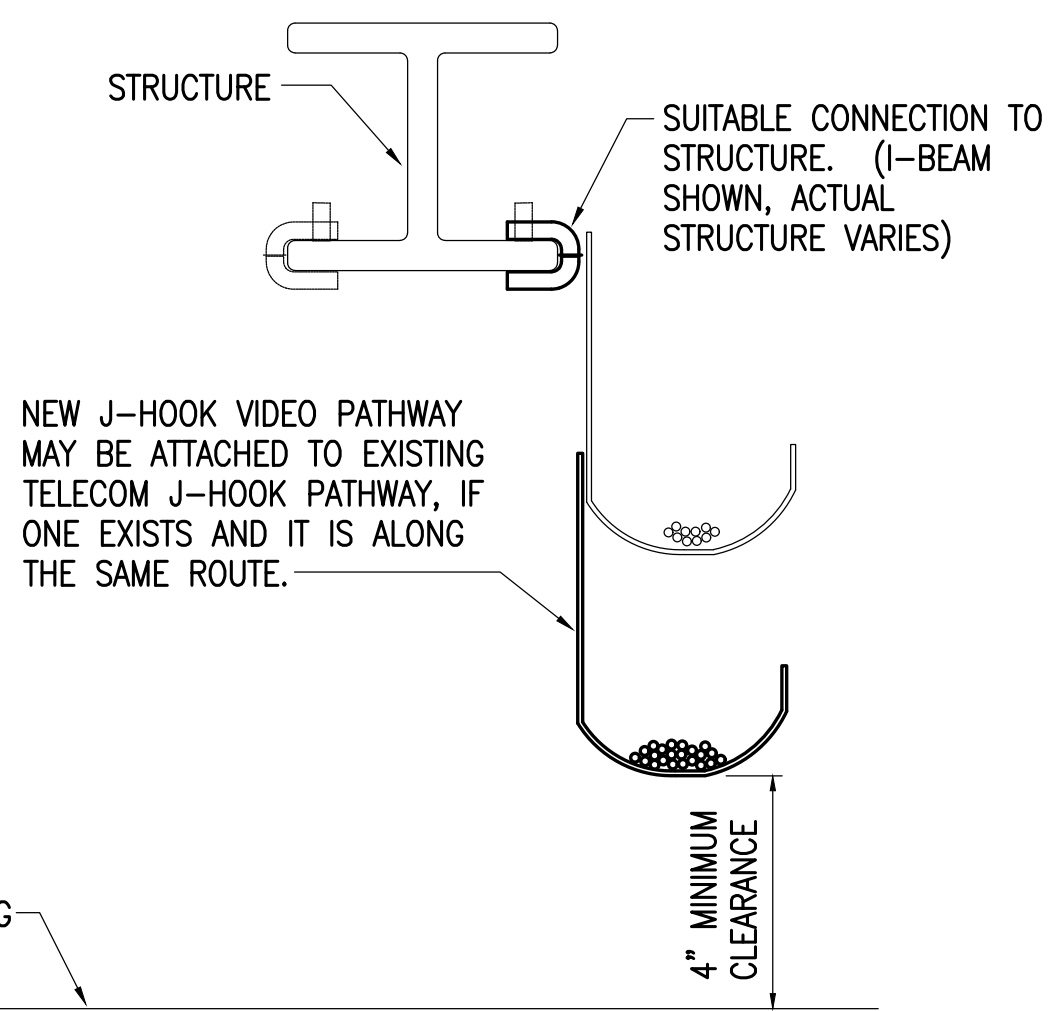

**DETAIL NOTES:**

- A. PROVIDE CONTINUOUS J-HOOK SUPPORT FOR ALL CABLING NOT REQUIRED TO BE INSTALLED IN CONDUIT AND WHERE CABLE TRAY OR RACEWAYS ARE NOT PROVIDED.
- B. SEE THE SPECIFICATIONS FOR J-HOOK RATINGS, SPACING CRITERIA AND SPARE CAPACITY REQUIREMENTS.
- C. PROVIDE ADDITIONAL SEPARATE J-HOOK PATHWAYS FOR EACH SYSTEM. CABLES SHALL NOT BE INTERMIXED BUT J-HOOKS FOR MULTIPLE SYSTEMS MAY BE CONNECTED TO THE SAME SUPPORT STRUCTURE.
- D. PROVIDE SPECIFIC MOUNTING HARDWARE FOR SUPPORT TO STRUCTURE TYPES AS NECESSARY. J-HOOKS MUST BE INSTALLED VERTICALLY AS SHOWN.

**2 J-HOOK DETAIL-LOW VOLTAGE CABLING**  
NOT TO SCALE

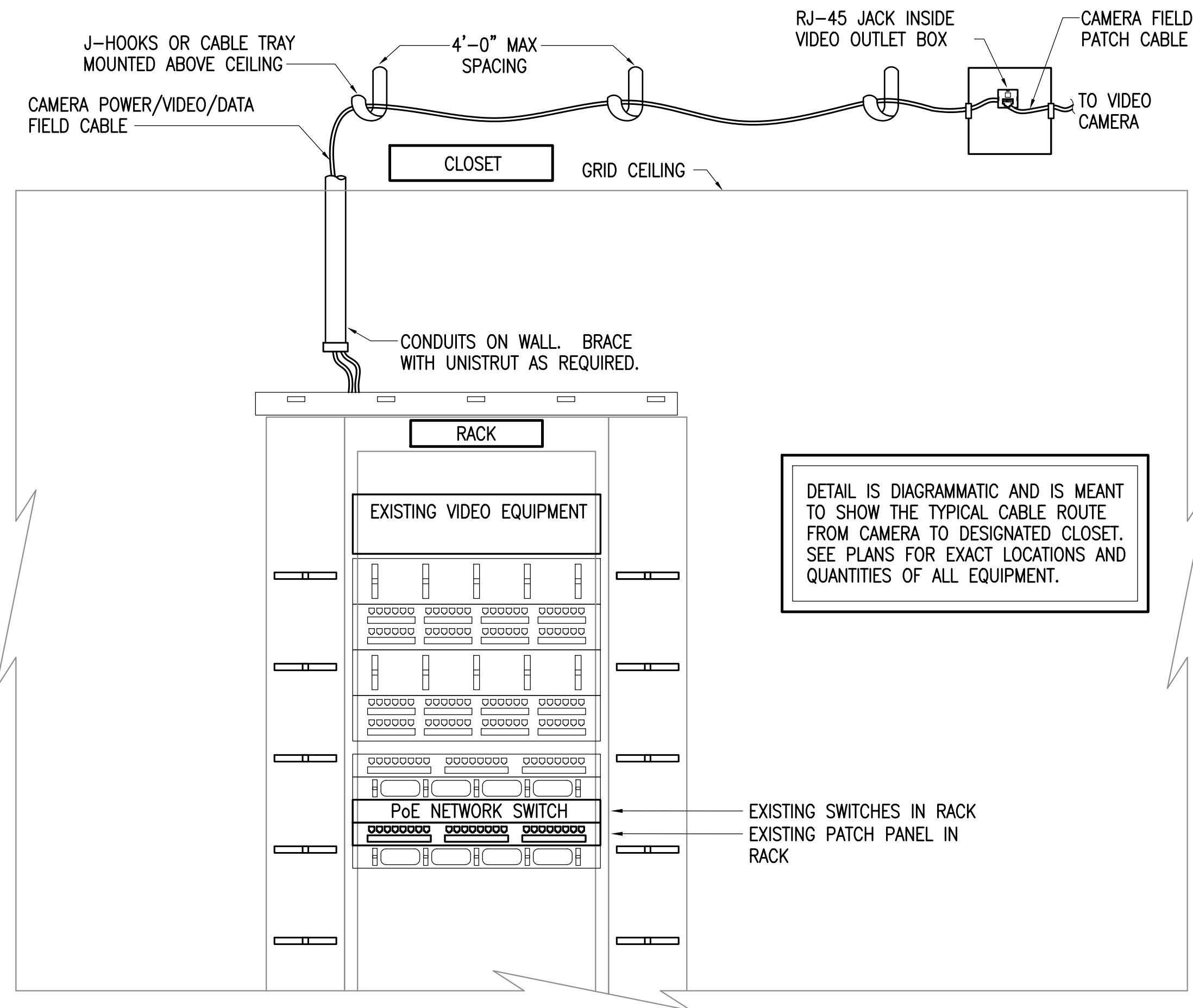

**3 VIDEO FIELD CABLE ROUTING DETAIL**  
NOT TO SCALE



**RISA**  
**Engineering, Inc.**  
MECHANICAL AND ELECTRICAL CONSULTING ENGINEERS  
670 West Fireweed Lane, Suite 200  
Anchorage, AK 99503  
Phone (907) 276-0521  
Corporate No.: AECC542

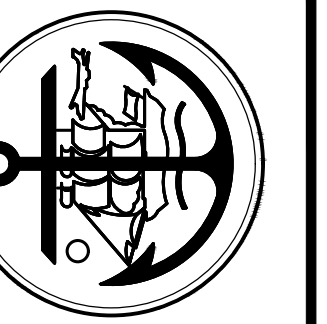

**MUNICIPALITY OF ANCHORAGE**  
**AFD FIRE VEHICLE MAINTENANCE FACILITY**  
**VIDEO SYSTEM REPLACEMENT**  
1000 AIRPORT HEIGHTS,  
ANCHORAGE, AK 99508

REVISIONS:

DRAWN BY: NDZ  
CHECKED BY: CSZ,JAM  
DATE: 2/13/2026  
JOB NUMBER: M5136  
DWG FILE: ESERIES

DRAWING TITLE:  
ELECTRICAL DETAILS

SHEET:  
**E003**

100% CONSTRUCTION DOCUMENTS

0"  
1"  
2"  
3"

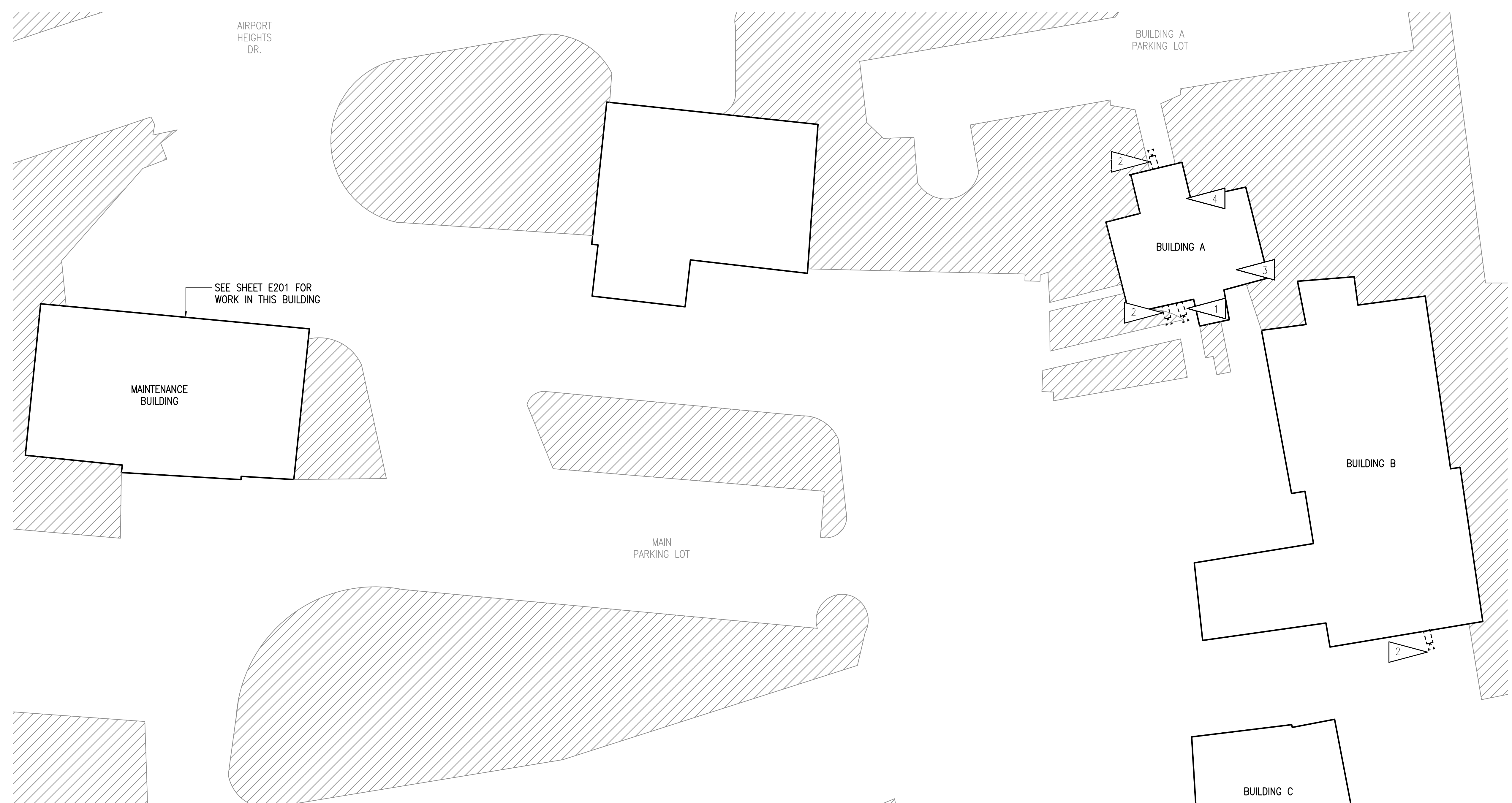

**1 VIDEO SYSTEM SITE DEMOLITION PLAN**  
NOT TO SCALE

**GENERAL NOTES:**

- A. THE INFORMATION SHOWN ON THIS DRAWING IS TAKEN FROM RECORD DRAWINGS AND A NON-DESTRUCTIVE WALK THROUGH OF THE FACILITY. THERE IS NO WARRANTY OR GUARANTEE AS TO THE ACCURACY OF THE INFORMATION SHOWN HERE-IN. THE CONTRACTOR SHALL FIELD VERIFY ALL ITEMS SCHEDULED FOR DEMOLITION PRIOR TO START OF WORK.
- B. THE OWNER SHALL HAVE FIRST RIGHT OF REFUSAL ON ALL SALVAGEABLE MATERIALS. THE CONTRACTOR SHALL DELIVER SALVAGED MATERIALS AS DIRECTED BY THE OWNER. THE CONTRACTOR SHALL DISPOSE OF, OFF SITE, ALL UNWANTED MATERIALS.
- C. DASHED OR DOTTED LINES INDICATE ITEMS TO BE REMOVED. SOLID LINES INDICATE EXISTING ITEMS TO REMAIN.

**SHEET NOTES:**

- 1. DEMOLISH CAMERA AND ASSOCIATED JUNCTION BOXES, CONDUIT AND CABLING BACK TO SOURCE.
- 2. DEMOLISH CAMERA AND PATCH CABLE. SALVAGE HORIZONTAL CABLING FOR CONNECTION TO NEW CAMERA IN SAME LOCATION.
- 3. DEMOLISH EXISTING CLIENT WORKSTATION AND MONITOR IN BASEMENT SERVER ROOM.
- 4. DEMOLISH EXISTING CLIENT WORKSTATION AND MONITOR IN ROOM 301.



**R S A**  
**Engineering, Inc.**  
MECHANICAL AND ELECTRICAL CONSULTING ENGINEERS  
670 West Fireweed Lane, Suite 200  
Anchorage, AK 99503  
Phone (907) 276-0521  
Corporate No.: AECC542

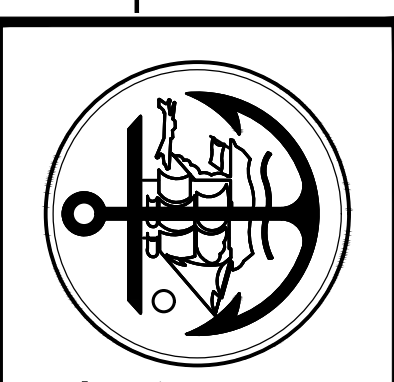

**MUNICIPALITY OF ANCHORAGE**  
**AFD FIRE VEHICLE MAINTENANCE FACILITY**  
**VIDEO SYSTEM REPLACEMENT**  
1000 AIRPORT HEIGHTS,  
ANCHORAGE, AK 99508

REVISIONS:

DRAWN BY: NDZ  
CHECKED BY: CSZ,JAM  
DATE: 2/13/2026  
JOB NUMBER: M5136  
DWG FILE: ESERIES

DRAWING TITLE:  
VIDEO SYSTEM SITE  
DEMOLITION PLAN

SHEET:  
**E101**

100% CONSTRUCTION DOCUMENTS

0"  
1"  
2"  
3"



**RISA**  
**Engineering, Inc.**  
MECHANICAL AND ELECTRICAL CONSULTING ENGINEERS  
670 West Fireweed Lane, Suite 200  
Anchorage, AK 99503  
Phone (907) 276-0521  
Corporate No.: AECC542

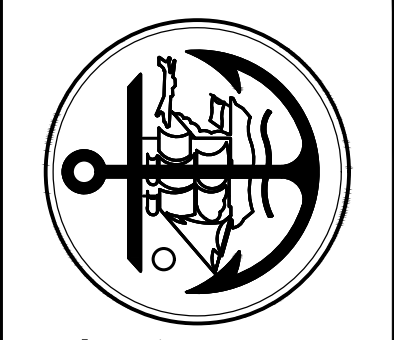

**MUNICIPALITY OF ANCHORAGE**  
**AFD FIRE VEHICLE MAINTENANCE FACILITY**  
**VIDEO SYSTEM REPLACEMENT**  
1000 AIRPORT HEIGHTS,  
ANCHORAGE, AK 99508

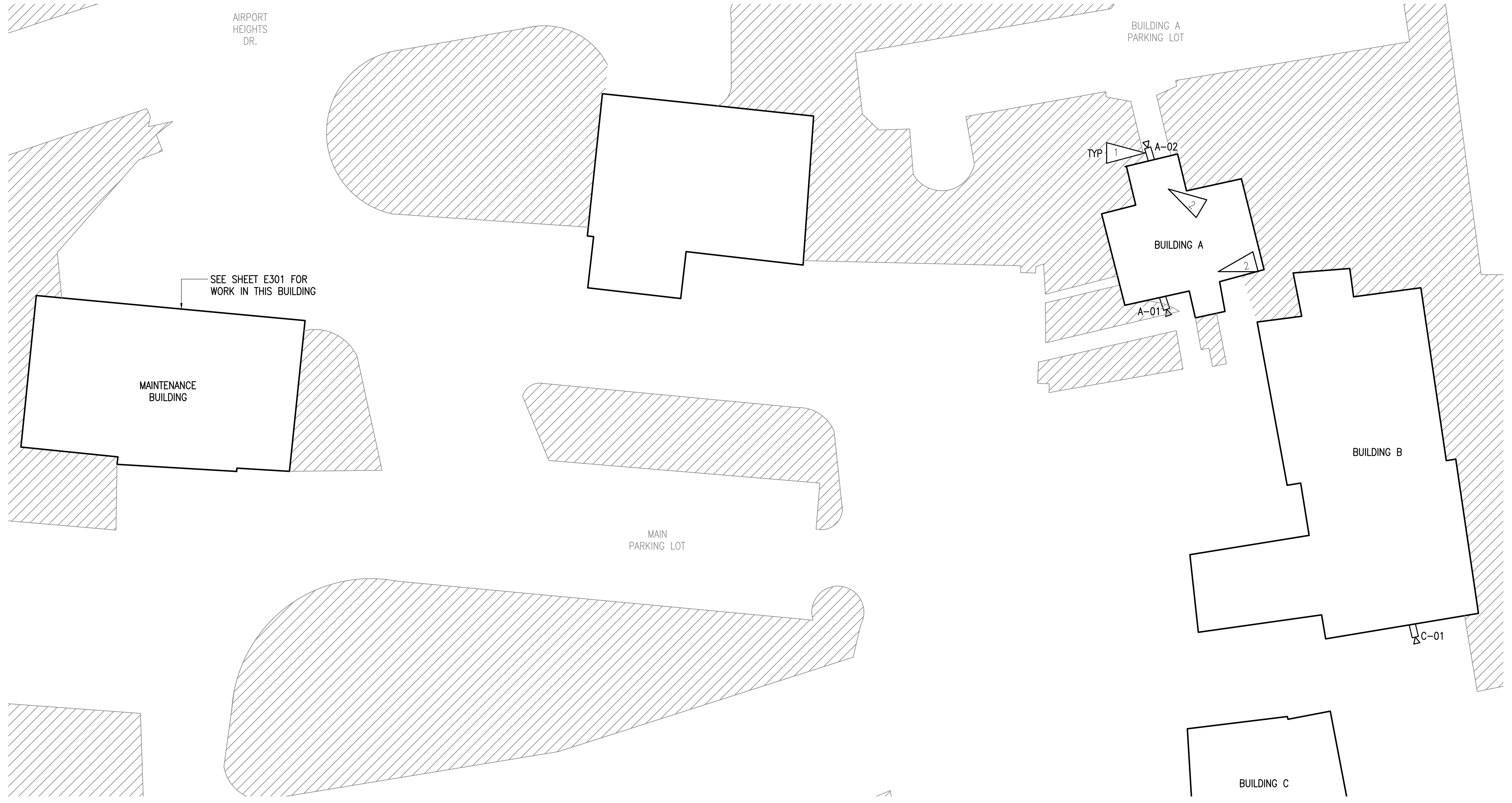

**1 VIDEO SYSTEM SITE REMODEL PLAN**  
NOT TO SCALE

**GENERAL NOTES:**

- A. AT THE CONTRACTOR'S OPTION, THE EXISTING MOUNTING HARDWARE FOR CAMERAS THAT ARE NEW AT EXISTING LOCATIONS MAY BE RE-USED IF COMPATIBLE WITH THE NEW CAMERAS.
- B. CAMERAS SHALL BE INSTALLED OUT OF THE DIRECT PATH OF SLIDING SNOW AND/OR ICE.
- C. APPROXIMATE LOCATIONS OF ALL CAMERAS AND MONITORS ARE SHOWN. EXACT LOCATIONS SHALL BE DETERMINED BY THE CONTRACTOR PRIOR TO THE START OF WORK. COORDINATE LOCATIONS TO AVOID OBSTRUCTIONS AND/OR DAMAGE.
- D. SEE SHEET E001 FOR VIDEO SYSTEM ONE-LINE DIAGRAM AND CAMERA SCHEDULE.
- E. SEE SHEET E003 FOR DETAILS.

**SHEET NOTES:**

- 1. NEW CAMERA AND ASSOCIATED PATCH CORD AT EXISTING LOCATION. PROVIDE NEW PATCH CORD TO INTERIOR.
- 2. NEW CLIENT WORKSTATION AND MONITOR IN EXISTING LOCATION. RECONNECT TO EXISTING NETWORK CABLING.

100% CONSTRUCTION DOCUMENTS

REVISIONS:
------------

DRAWN BY:	NDZ
CHECKED BY:	CSZ,JAM
DATE:	2/13/2026
JOB NUMBER:	M5136
DWG FILE:	ESERIES

DRAWING TITLE:
VIDEO SYSTEM SITE REMODEL PLAN

SHEET:
E102

0"  
1"  
2"  
3"

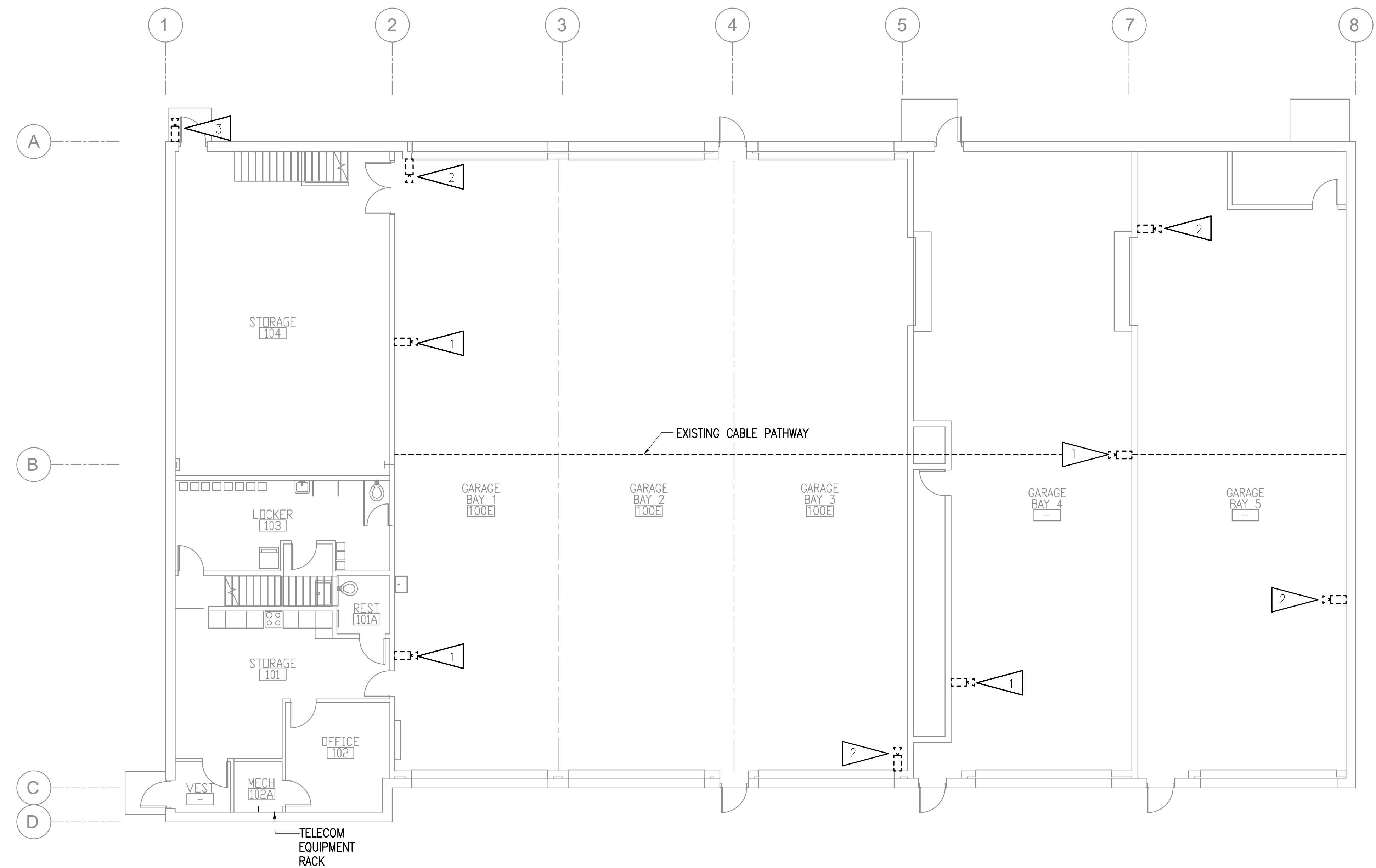

**1** MAINTENANCE BUILDING VIDEO SYSTEM DEMOLITION PLAN  
1/8"=1'-0"

**GENERAL NOTES:**

A. SEE E101 FOR GENERAL NOTES.

**SHEET NOTES:**

1. DEMOLISH CAMERA AND ASSOCIATED JUNCTION BOXES, CONDUIT AND CABLING BACK TO SOURCE.
2. DEMOLISH CAMERA AND SALVAGE CABLING FOR NEW CAMERA IN SAME/ NEARBY LOCATION.
3. DEMOLISH CAMERA AND ASSOCIATED PATCH CORD. SALVAGE HORIZONTAL CABLING FOR CONNECTION TO NEW CAMERA IN EXISTING LOCATION.



**RISA**  
**Engineering, Inc.**  
MECHANICAL AND ELECTRICAL CONSULTING ENGINEERS  
670 West Fireweed Lane, Suite 200  
Anchorage, AK 99503  
Phone (907) 276-0521  
Corporate No.: AECC542

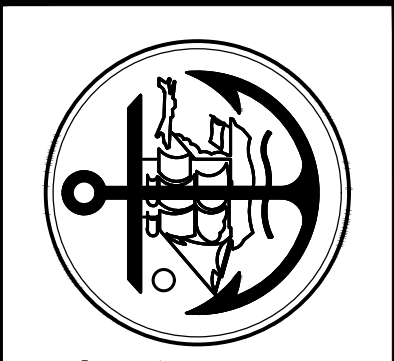

**MUNICIPALITY OF ANCHORAGE**  
**AFD FIRE VEHICLE MAINTENANCE FACILITY**  
**VIDEO SYSTEM REPLACEMENT**  
1000 AIRPORT HEIGHTS,  
ANCHORAGE, AK 99508

REVISIONS:

--	--

DRAWN BY:	NDZ
CHECKED BY:	CSZ,JAM
DATE:	2/13/2026
JOB NUMBER:	M5136
DWG FILE:	ESERIES

DRAWING TITLE:	MAINTENANCE BUILDING VIDEO SYSTEM DEMOLITION PLAN
----------------	---

SHEET:	E201
--------	------

100% CONSTRUCTION DOCUMENTS



**RSA Engineering, Inc.**  
 MECHANICAL AND ELECTRICAL CONSULTING ENGINEERS  
 670 West Fireweed Lane, Suite 200  
 Anchorage, AK 99503  
 Phone (907) 276-0521  
 Corporate No.: AECC542

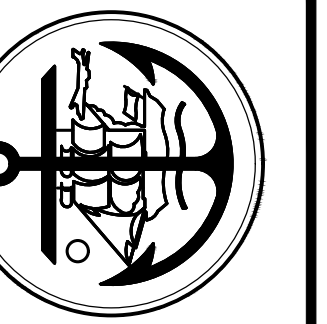

**MUNICIPALITY OF ANCHORAGE**  
**AFD FIRE VEHICLE MAINTENANCE FACILITY**  
**VIDEO SYSTEM REPLACEMENT**  
 1000 AIRPORT HEIGHTS,  
 ANCHORAGE, AK 99508

REVISIONS:

DRAWN BY: NDZ  
 CHECKED BY: CSZ,JAM  
 DATE: 2/13/2026  
 JOB NUMBER: M5136  
 DWG FILE: ESERIES

DRAWING TITLE:  
 MAINTENANCE BUILDING  
 VIDEO SYSTEM  
 REMODEL PLAN

SHEET:  
**E301**

100% CONSTRUCTION DOCUMENTS

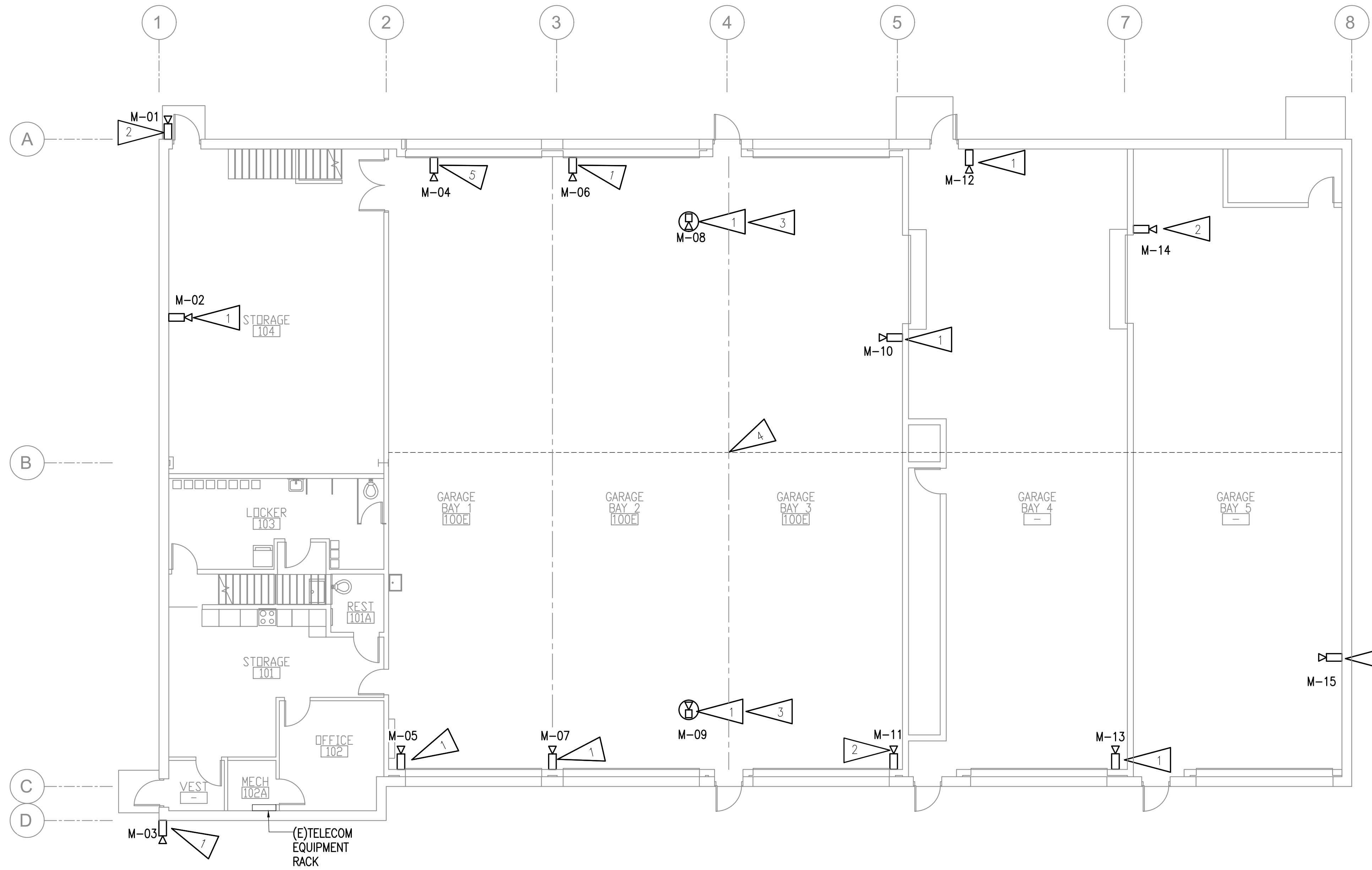

**1 MAINTENANCE BUILDING VIDEO SYSTEM REMODEL PLAN**  
 1/8"=1'-0"

**GENERAL NOTES:**

- A. SEE E102 FOR GENERAL NOTES.
- B. CABLE ROUTED ALONG WALLS SHALL BE INSTALLED IN CONDUIT.
- C. AT THE CONTRACTORS OPTION TELECOM CABLE PATHWAYS AND RACEWAYS MAY BE RE-USED WHERE IN COMPLIANCE WITH THE SPECIFICATIONS.

**SHEET NOTES:**

- 1. NEW CAMERA AT NEW LOCATION.
- 2. NEW CAMERA AT EXISTING LOCATION.
- 3. MOUNT CAMERA TO UNDERSIDE OF I BEAM.
- 4. EXISTING CABLING ROUTED IN CABLE PATHWAY IN EXPOSED CEILING.
- 5. NEW CAMERA AT NEARBY LOCATION. AT CONTRACTOR'S OPTION, EXISTING VIDEO CAMERA CABLING MAY BE REUSED TO FEED NEW CAMERA WHERE IN COMPLIANCE WITH THE SPECIFICATIONS. OTHERWISE CONTRACTOR SHALL PROVIDE NEW.

